

***Notes*:**

- Constructed with vinyl ester filament wound fiberglass laminate with UV inhibitors
- 50 psi working pressure
- Filtration rate of 5 – 15 GPM/SF
- Sand bed type #20 silica NSF 50
- Automatic air relief valve included
- Filter media sold separately
- All units are in inches unless otherwise specified

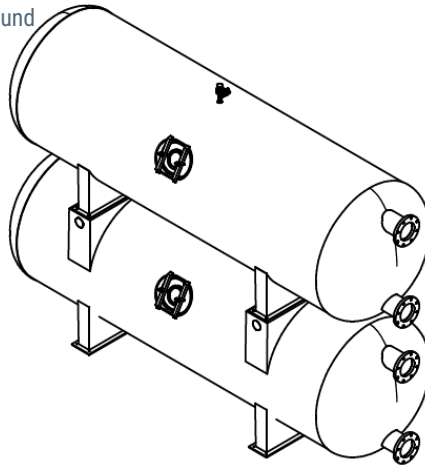

Filter Properties

| | |
|----------------------------------|--------------------|
| Filter Diameter | 60 in |
| Filtration Area (Total) | 160 SF |
| Filter Rate | 800 – 2400 GPM/SF |
| Backwash Rate (Per Filter) | 1200 – 1600 GPM/SF |
| Filter Flanges | 8 in |
| Manway Location | Left |
| Media Quantity (Per Filter) | 183.2 CF |
| Optional Pea Gravel (Per Filter) | 33.1 CF |
| Dry Weight | 3125 lbs |

Filter Dimensions

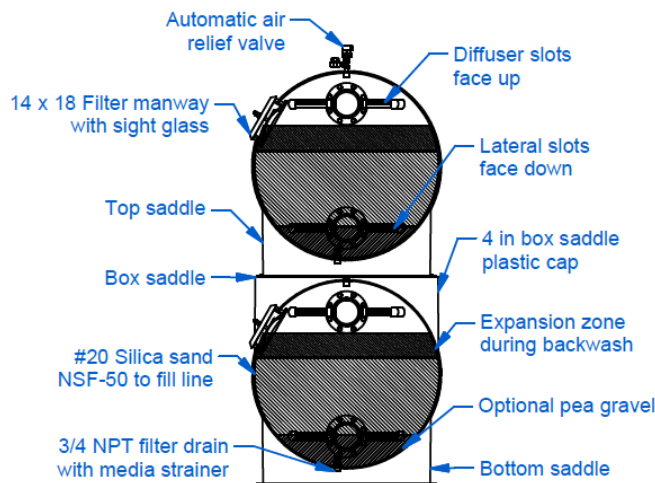
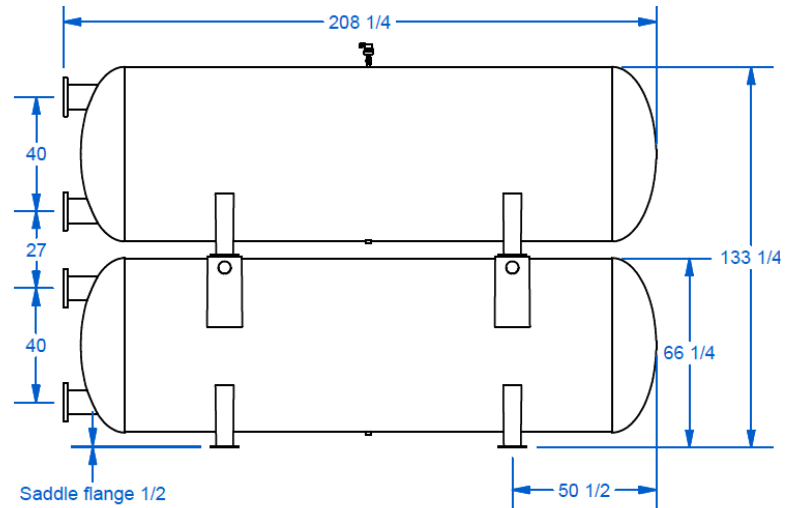
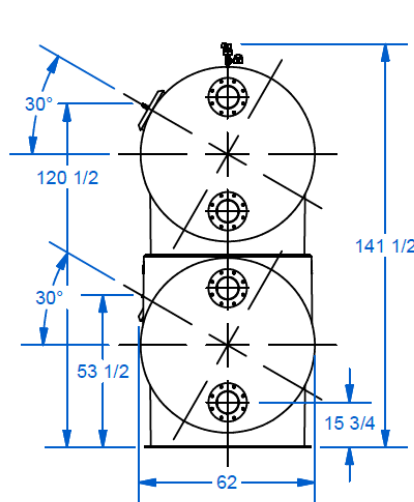

Saddle Dimensions

