

**\*Notes\*:**

- Constructed with vinyl ester filament wound fiberglass laminate with UV inhibitors
- 50 psi working pressure
- Filtration rate of 5 – 15 GPM/SF
- Sand bed type #20 silica NSF 50
- Automatic air relief valve included
- Filter media sold separately
- All units are in inches unless otherwise specified

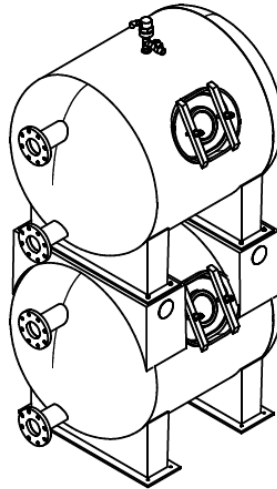

**Filter Properties**

Filter Diameter	42 in
Filtration Area (Total)	30 SF
Filter Rate	150 – 450 GPM/SF
Backwash Rate (Per Filter)	225 – 300 GPM/SF
Filter Flanges	4 in
Manway Location	Right
Media Quantity (Per Filter)	21.3 CF
Optional Pea Gravel (Per Filter)	4.9 CF
Dry Weight	725 lbs

## Filter Dimensions

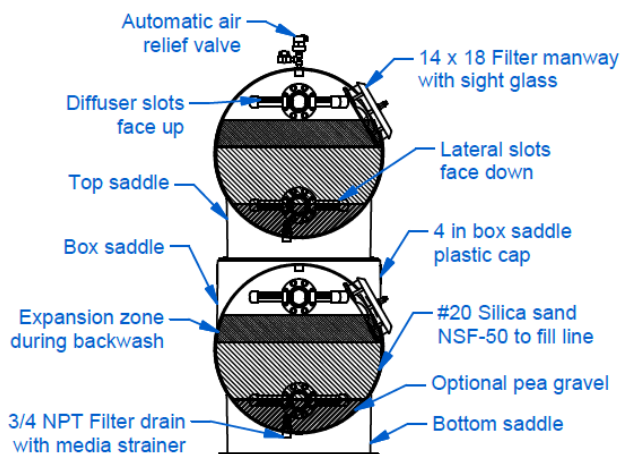
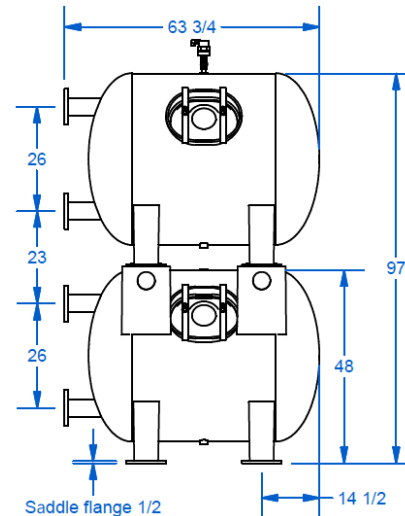
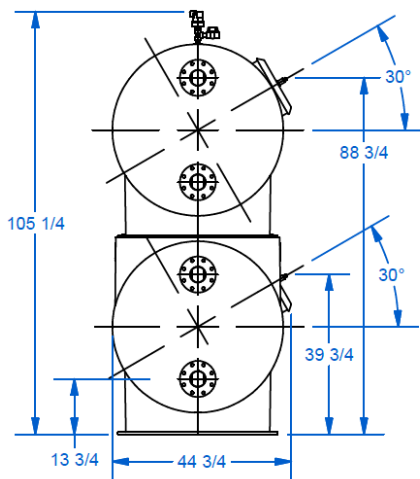

## Saddle Dimensions

